

InFocus Information

SAR Information

THIS MOBILE DEVICE MEETS GUIDELINES FOR EXPOSURE TO RADIO WAVES. Your mobile device is a radio transmitter and receiver. It is designed not to exceed the limits for exposure to radio waves recommended by international guidelines. These guidelines were developed by the independent scientific organization ICNIRP and include safety margins designed to assure the protection of all persons, regardless of age and health.

The exposure guidelines for mobile devices employ a unit of measurement known as the Specific Absorption Rate or SAR. The SAR limit stated in the ICNIRP guidelines is 1.6 W/kg averaged over 1 grams of tissue. Tests for SAR are conducted using standard operating positions with the device transmitting at its highest certified power level in all tested frequency bands. The actual SAR level of an operating device can be below the maximum value because the device is designed to use only the power required to reach the network. That amount changes depending on a number of factors such as how close you are to a network base station. The highest SAR value under the ICNIRP guidelines for use of the device at the ear is X.XXX W/kg and at the body is X.XXX W/kg (The measure distance of 1.5 cm). Use of device accessories and enhancements may result in different SAR values. SAR values may vary depending on national reporting and testing requirements and the network band.

Limited warranty

InFocus provides "Product Warranty Statement", at the time of its original purchase, from the InFocus or its authorized distributor, describing the product warranty service.

Notes: InFocus does not provide global cross border warranty.

This limited warranty (free of defects in materials and workmanship causing malfunction and defective) shall last for twelve (12) months for the device and six (6) months for the battery from the purchase date. Other than battery, the in-box accessories, including cosmetic parts, button, cables, earphone, AC ... etc. if applied; six (6) month open-box functional failure warranty is provided. The customer shall present the **PROOF OF PURCHASE** upon claiming the warranty. Throughout the warranty period InFocus or its authorized agent will, at own discretion and subject to section Non-Warranty below repair or replace a defective product. All replaced defective parts or components will become the property of InFocus after returning the repaired/replaced product in good working condition. This repair on the same symptom, one (1) month repair warranty is provided.

Any damage of the device caused by a SIM card misuse, including but not limited to insert a SIM card not provided by your mobile telecom operator, or use a SIM card cut by yourself, will be not covered under warranty and the repair service will be charged.

For more detailed information, see the User Guide.

www.infocusphone.com

Model Name : TSP



PKTSP55003A

InFocus

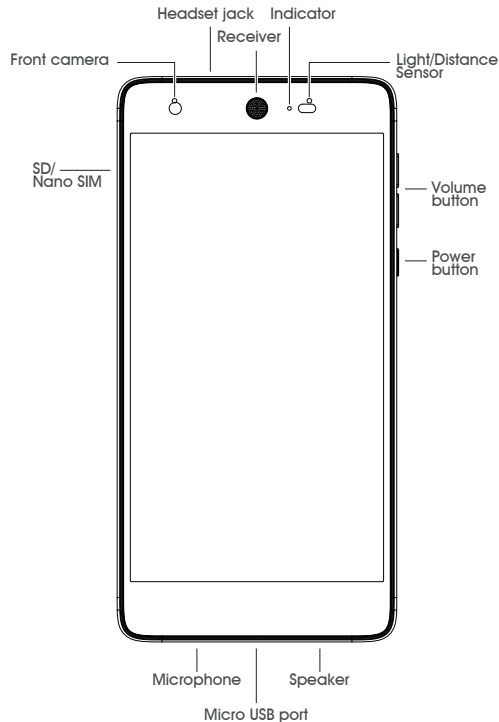

Quick Start Guide

Installing SIM Card and Micro SD

1. Locate the SIM card tray.

2. Use the included pin tool to open the tray.

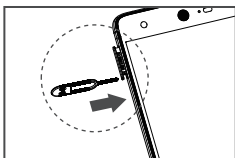

3. Place the SIM card on the tray and slide the tray back into the phone.

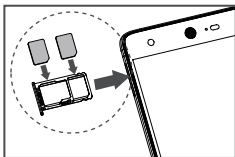

4. Locate the Micro SD tray.

5. Use the included pin tool to open the tray.

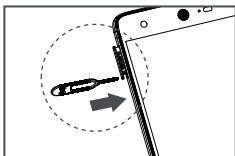

6. Place the Micro SD on the tray. Slide the tray back into the phone.

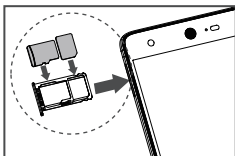

**Use the pin tool supplied in the box only to open the tray.
If the pin tool is lost, consult InFocus customer service.**

Charging the Battery

The battery is not fully charged when releasing the phone from the factory. It is recommended to charge the battery before use.

1. Connect the smaller end of the USB cable to the USB port of the device.

2. Connect the other end of the cable to the USB charging or other USB port with power source (for example, laptop). The phone's indicator lights on.

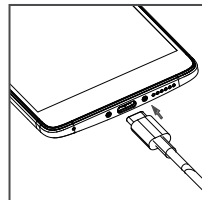

Warning

- Charge only indoors and in dry environments.
- For safety, the overheat protection will be active during charging. If the system temperature reaches above the maximum level, the device will automatically stop charging. The device will only resume charging when normal operating temperature is reached.
- If there is no response after you press the Power button or touch the panel, press and hold the "Power button" for 8 seconds to force shutdown. If you hold the "Power button" for 2 seconds more, it will restart.
- Use a wireless hands-free system (headphone, headset) with a low power Bluetooth emitter.
- Make sure the cell phone has a low SAR.
- Keep your calls short or send a text message (SMS) instead. This advice applies especially to children, adolescents and pregnant women.
- Use cell-phone when the signal quality is good.
- People having active medical implants should preferably keep the cell phone at least 15 cm away from the implant.